

Acoustic characteristics

The indicated values are determined by measuring the sound pressure level and sound power in dB(A) obtained in a free field at a distance equivalent to twice the size of the fan plus the impeller diameter, with a minimum of 1.5 m.

Sound power spectrum Lw(A) in dB(A) per Hz frequency band

	63	125	250	500	1000	2000	4000	8000
1919-4M-1/5 IE4	45	56	60	64	66	65	64	55
1919-6M-1/10 IE4	40	51	55	59	61	60	59	50
2525-4M-1/2 IE4	53	64	68	72	74	73	72	63
2525-4M-3/4 IE4	57	68	72	76	78	77	76	67
2525-4M-1 IE4	58	69	73	77	79	78	77	68
2525-6M-1/3 IE4	48	59	63	67	69	68	67	58
2828-4M-1 IE4	59	70	74	78	80	79	78	69
2828-4M-2 IE4	61	72	76	80	82	81	80	71
2828-6M-1/3 IE4	48	59	63	67	69	68	67	58
3333-6M-1 IE4	57	68	72	76	78	77	76	67

Dimensions mm

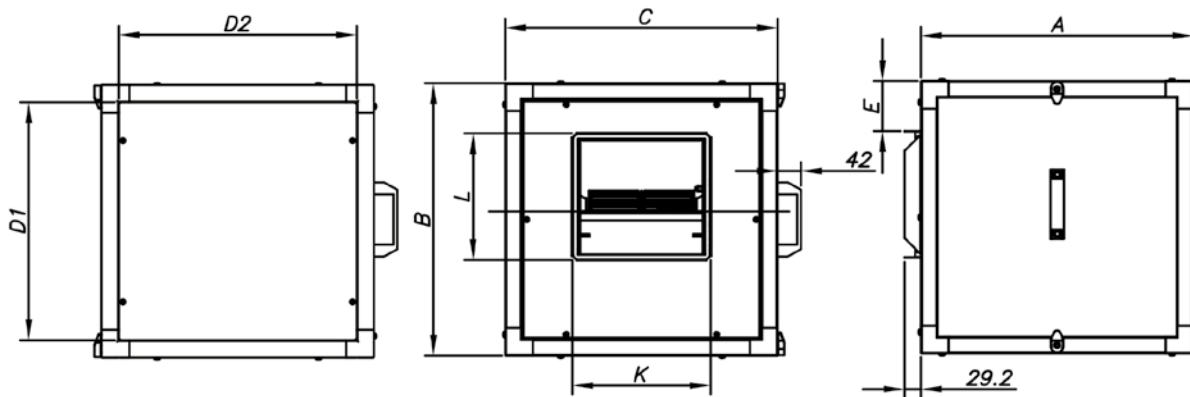

	Equivalence inches	A	B	C	D1	D2	E	L	K
CJBD/EC/AL-1919	7/7	490	490	490	428	428	91	226	247
CJBD/EC/AL-2525	9/9	550	550	550	488	488	86	279	317
CJBD/EC/AL-2828	10/10	605	605	605	543	543	88	306	343
CJBD/EC/AL-3333	12/12	680	680	680	618	618	84	360	404

Characteristic curves

See series characteristic curves: CBD/EC

Accessories



Characteristic curves

Q= Flow rate in m³/h, m³/s and cfm

Pe= Static pressure in mm H₂O, Pa and inwg

1919-4M-1/5 IE4

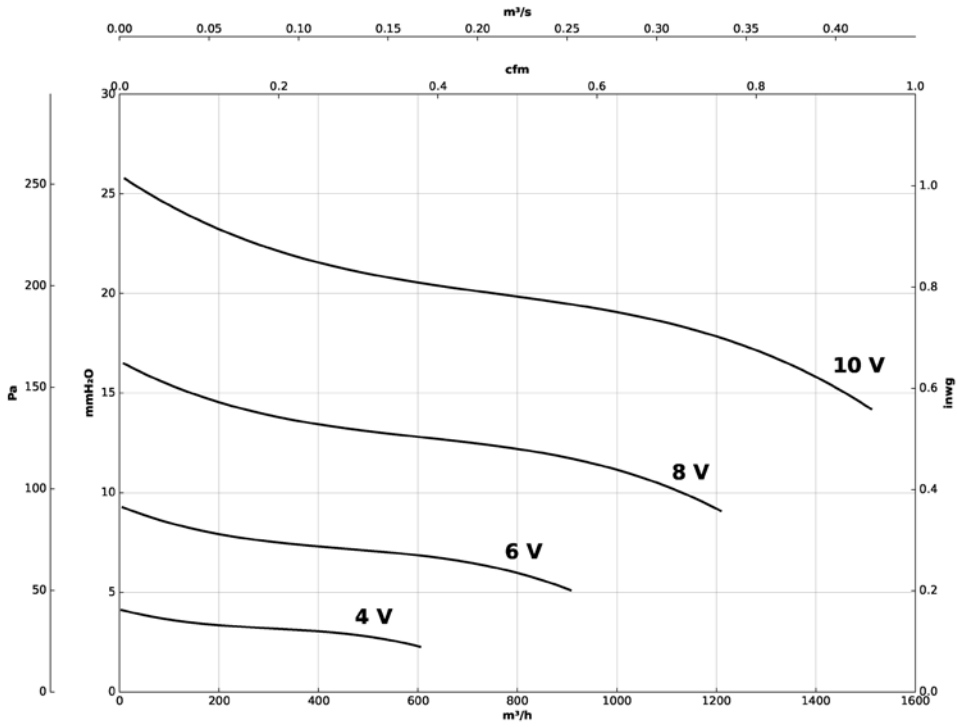

1919-6M-1/10 IE4

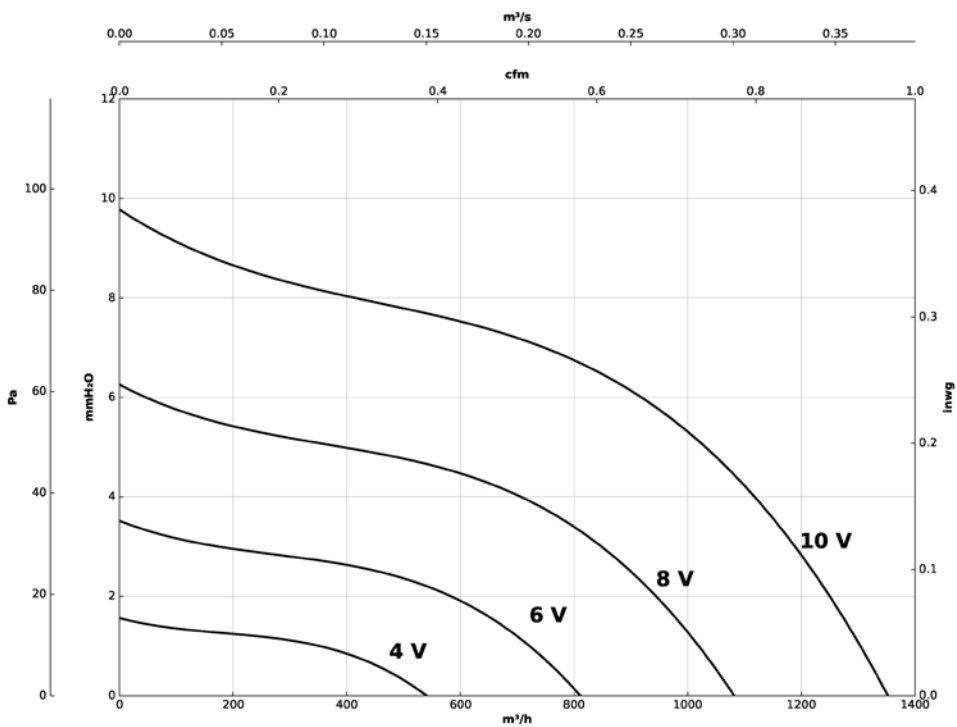

Characteristic curves

Q= Flow rate in m³/h, m³/s and cfm

Pe= Static pressure in mm H₂O, Pa and inwg

2525-4M-1/2 IE4

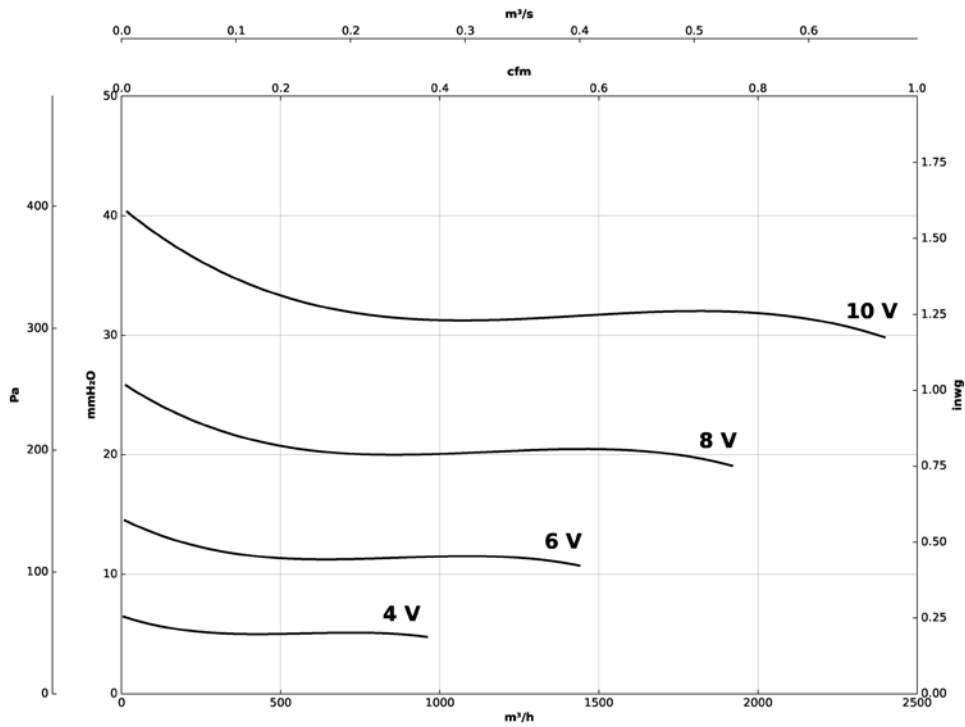

2525-4M-3/4 IE4

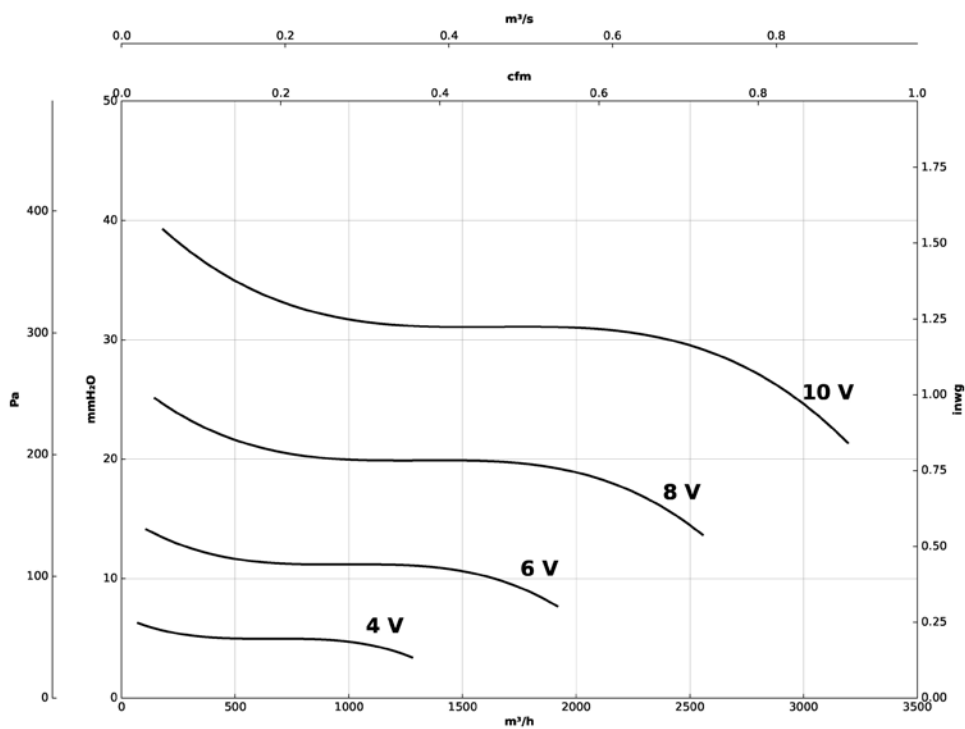

Characteristic curves

Q= Flow rate in m³/h, m³/s and cfm

Pe= Static pressure in mm H₂O, Pa and inwg

2525-4M-1 IE4

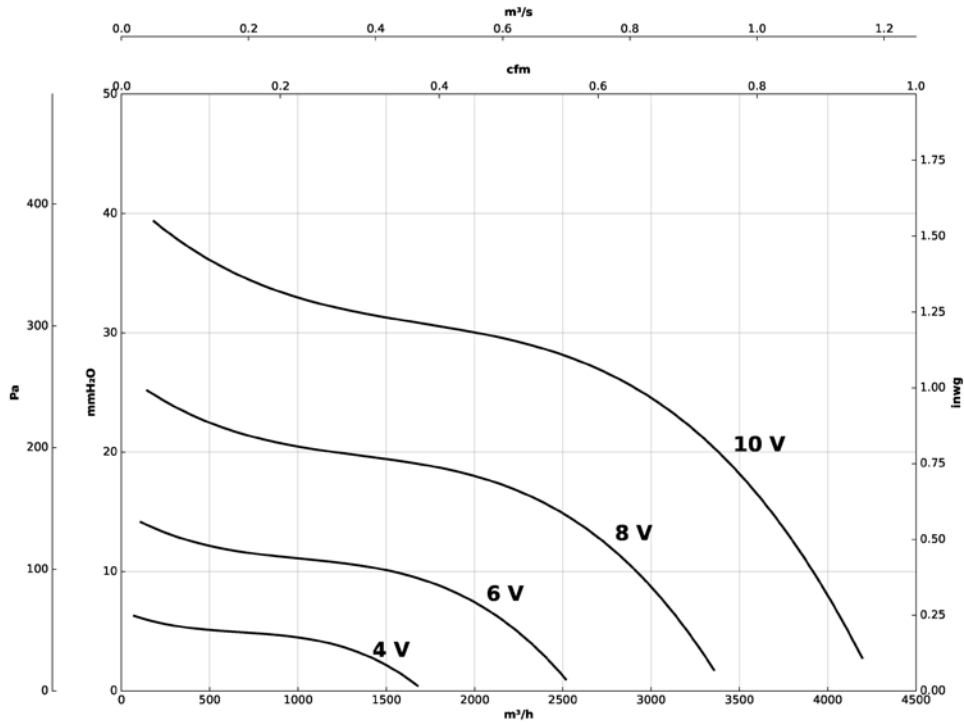

2525-6M-1/3 IE4

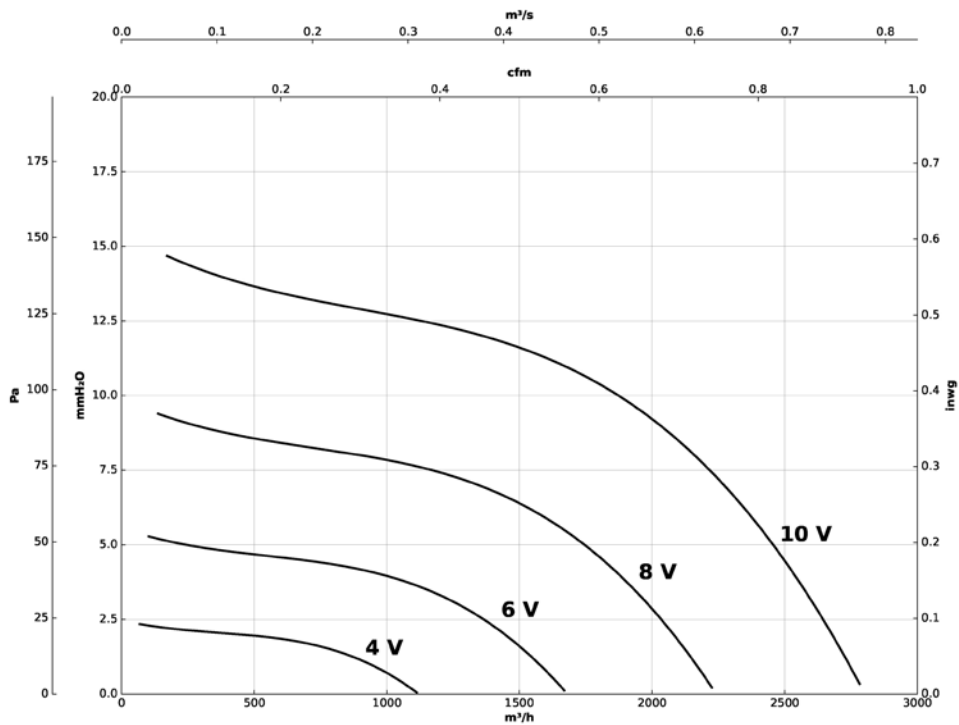

Characteristic curves

Q= Flow rate in m³/h, m³/s and cfm

Pe= Static pressure in mm H₂O, Pa and inwg

2828-4M-1 IE4

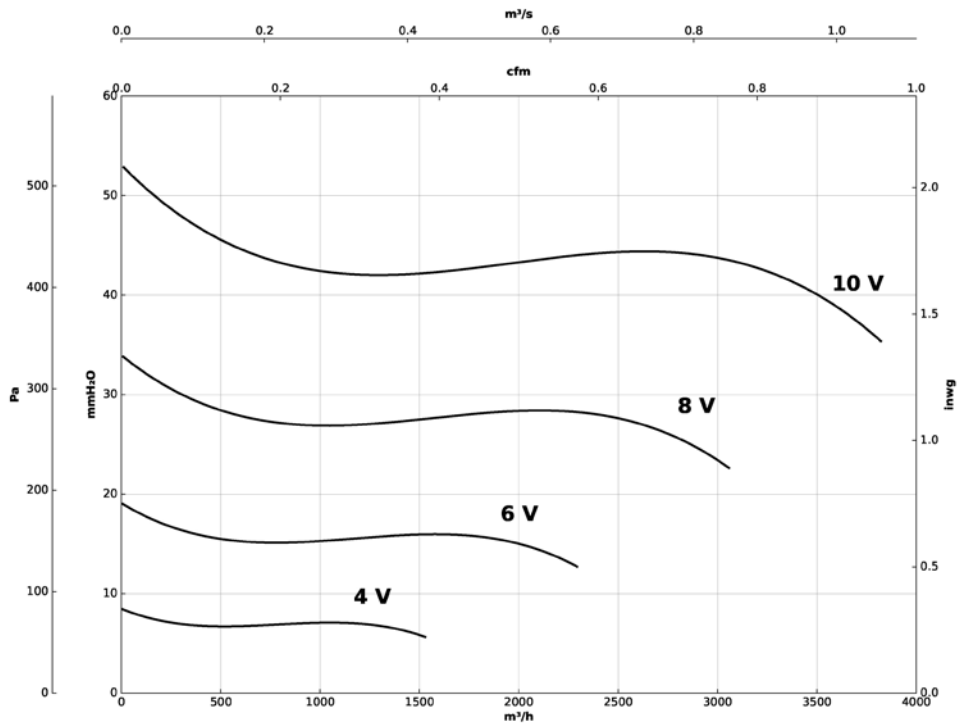

2828-4M-2 IE4

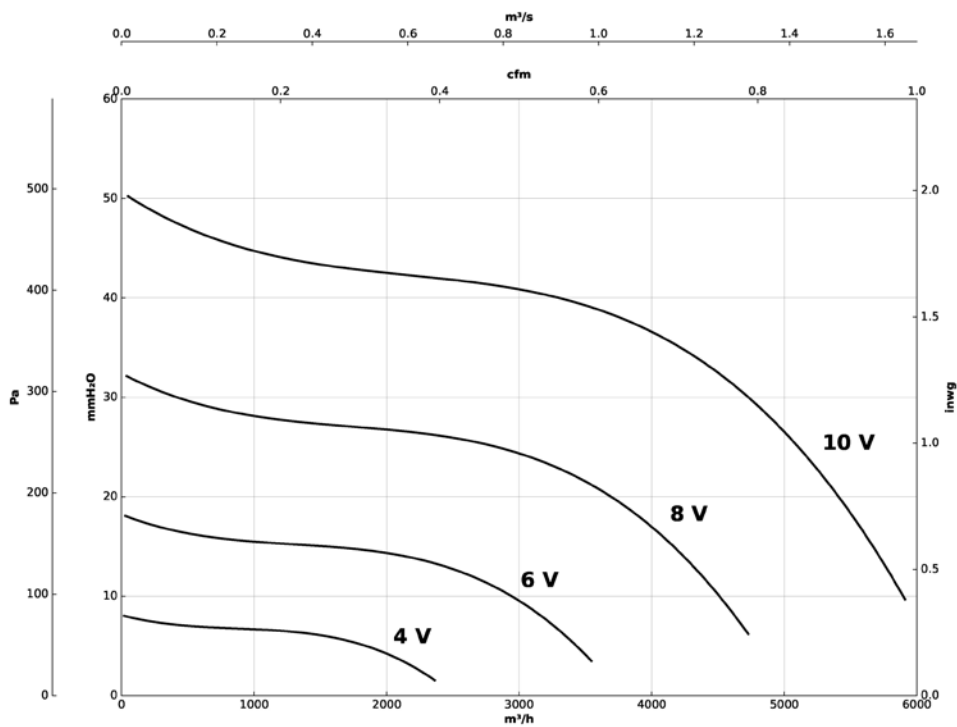

Characteristic curves

Q= Flow rate in m³/h, m³/s and cfm

Pe= Static pressure in mm H₂O, Pa and inwg

2828-6M-1/3 IE4

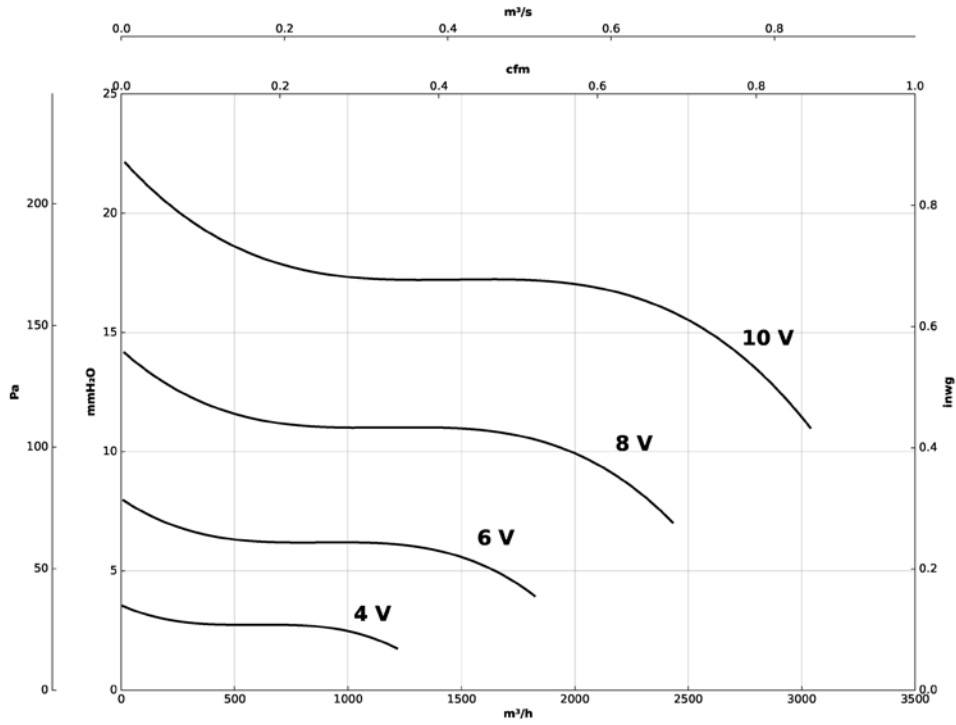

3333-6M-1 IE4

